

REFERENCE NUMBER
S73/2021/0337

SITE: Construction of grade separated
junction with associated access
roads, landscaping, drainage and
engineering works

SCALE 1:1250

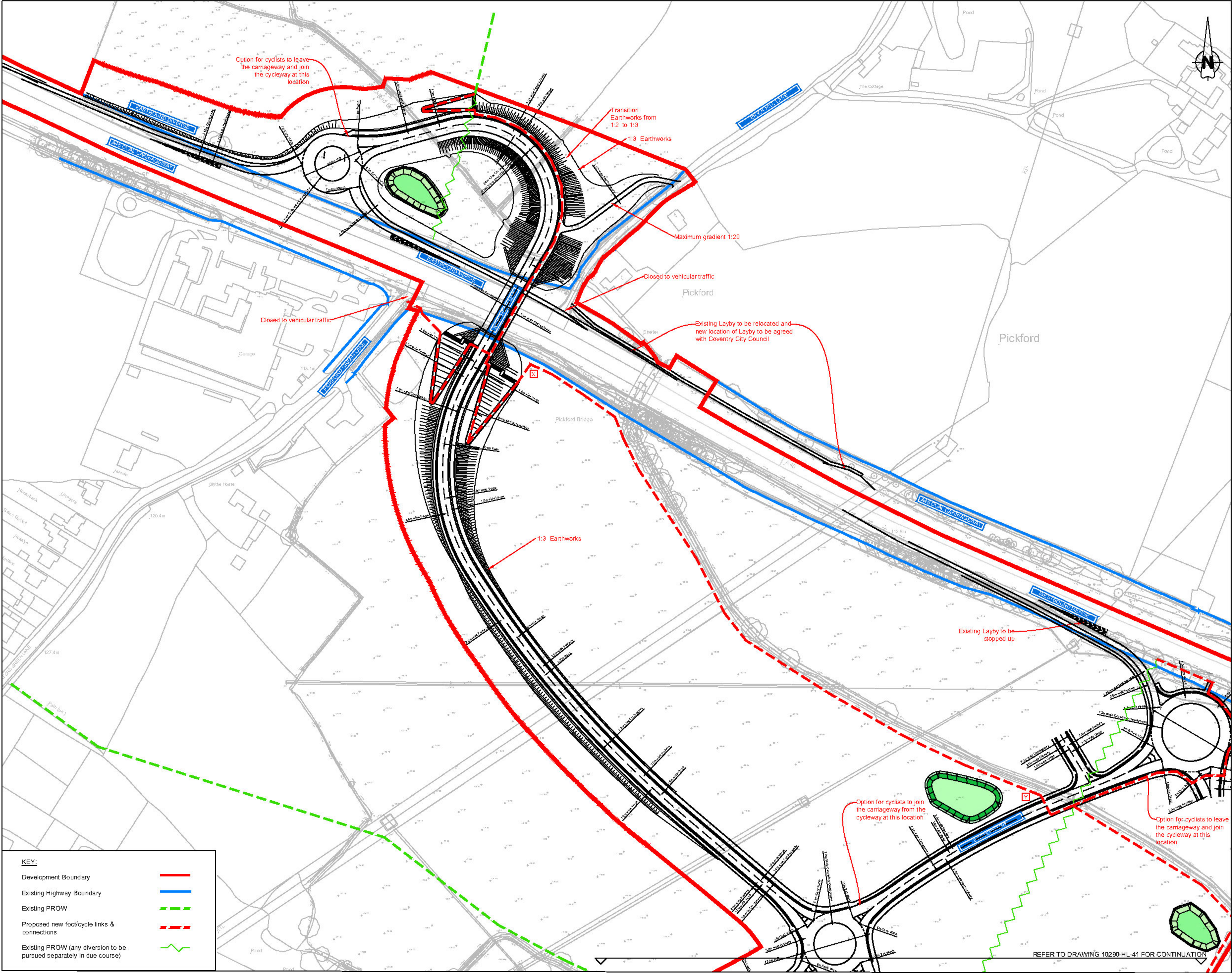

Construction Design and Management (CDM)
Key Residual Risks
Contractors entering the site should gain permission from the relevant land owners and/or principle contractor working on site at the time of entry. Contractors shall be responsible for carrying out their own risk assessments and for liaising with the relevant services companies and authorities. Listed below are Site Specific key risks associated with the project.

- 1) Overhead and underground services
- 2) Street Lighting Cables
- 3) Working adjacent to water courses and flood plain
- 4) Soft ground conditions
- 5) Working adjacent to live highways and railway line
- 6) Uncharted services
- 7) Existing buildings with potential asbestos hazards

NOTES:

1. Do not scale from this drawing.
2. This drawing has been based on survey data provided by a third party. Brookbanks Consulting Ltd cannot be held responsible for the accuracy of this information.
3. The junctions, roundabouts and links have been designed in accordance with the following DMRB standards:
 - TA 23/81: Junctions and Accesses - Determination of Size of Roundabouts and Major-Minor Junctions
 - TD 9/93: Highway Link Design
 - TD 16/07: Geometric Design of Roundabouts
 - TD 22/06: Layout of Grade Separated Junctions
 - Manual for Streets.
5. All highway layout and footway strategy information is subject to change following completion of the detailed design.

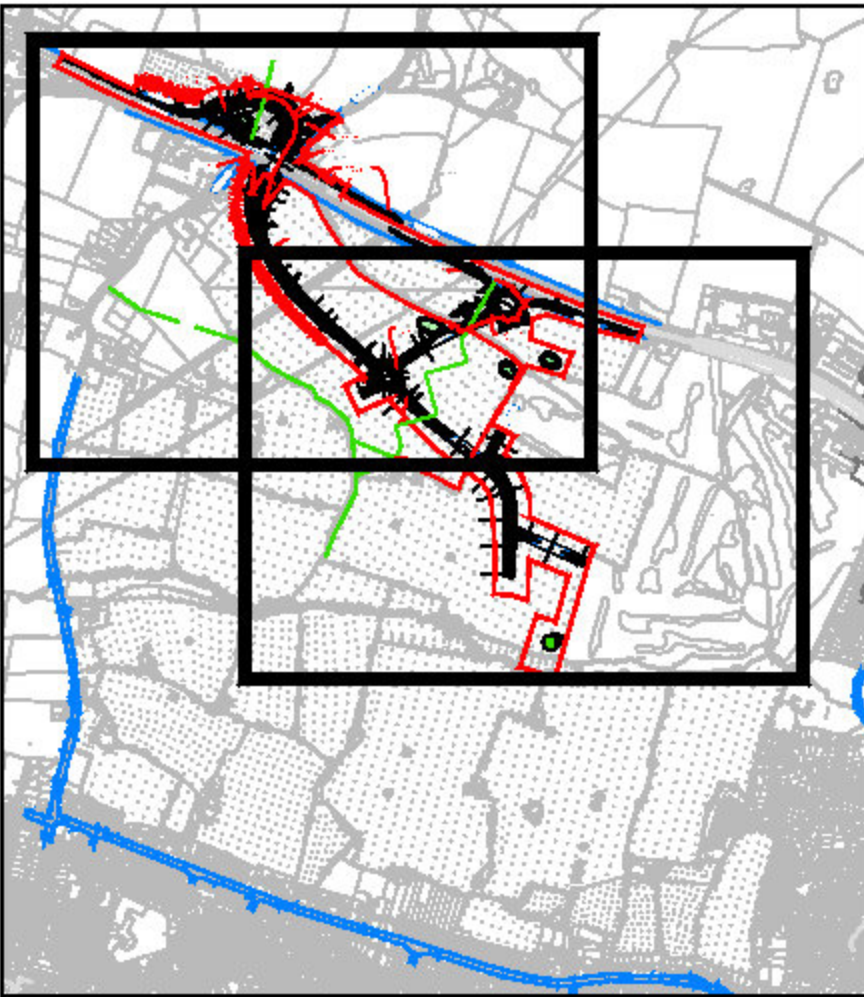

General Overview
(Not to Scale)

Brookbanks

6150 Knights Court, Solihull Parkway, Birmingham B37 7WY
Tel (0121) 329 4330 Fax (0121) 329 4331
www.brookbanks.com



Land North of Eastern Green
Coventry

A45 Pickford Green Interchange
General Arrangement Sheet 1

Status		Status Date	
For Comment		December 2017	
Drawn	Checked	Date	
MDM	LW	05.01.2017	
Scale	Number	Rev	
1:1250	10290-HL-40	G	
0 25 50 75 100 125			
METRES			

UNTIL TECHNICAL APPROVAL HAS BEEN OBTAINED FROM THE RELEVANT LOCAL AUTHORITIES, IT SHOULD BE UNDERSTOOD THAT ALL DRAWINGS ARE ISSUED AS PRELIMINARY AND NOT FOR CONSTRUCTION. SHOULD THE CONTRACTOR COMMENCE SITE WORK PRIOR TO APPROVAL BEING GIVEN, IT IS ENTIRELY AT HIS OWN RISK.

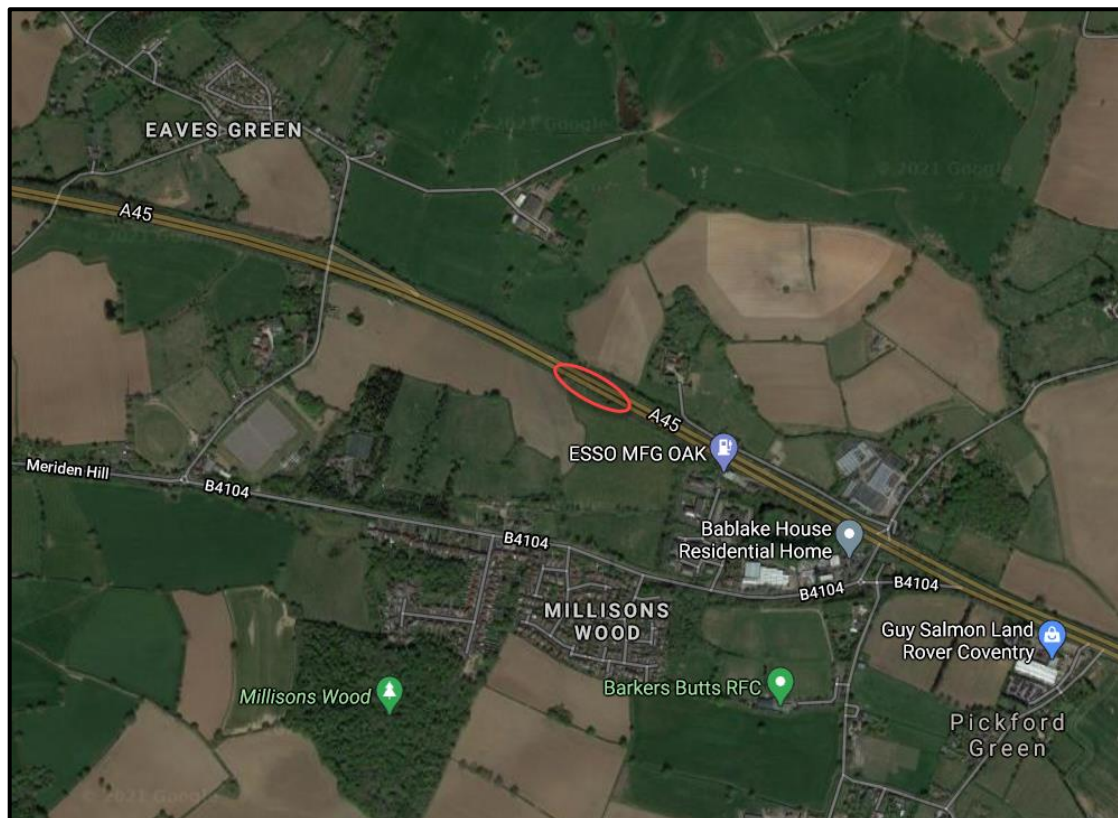

Client: Brookbanks Consulting Ltd

Scheme: Proposed Layby Improvements, A45 Westbound, Coventry

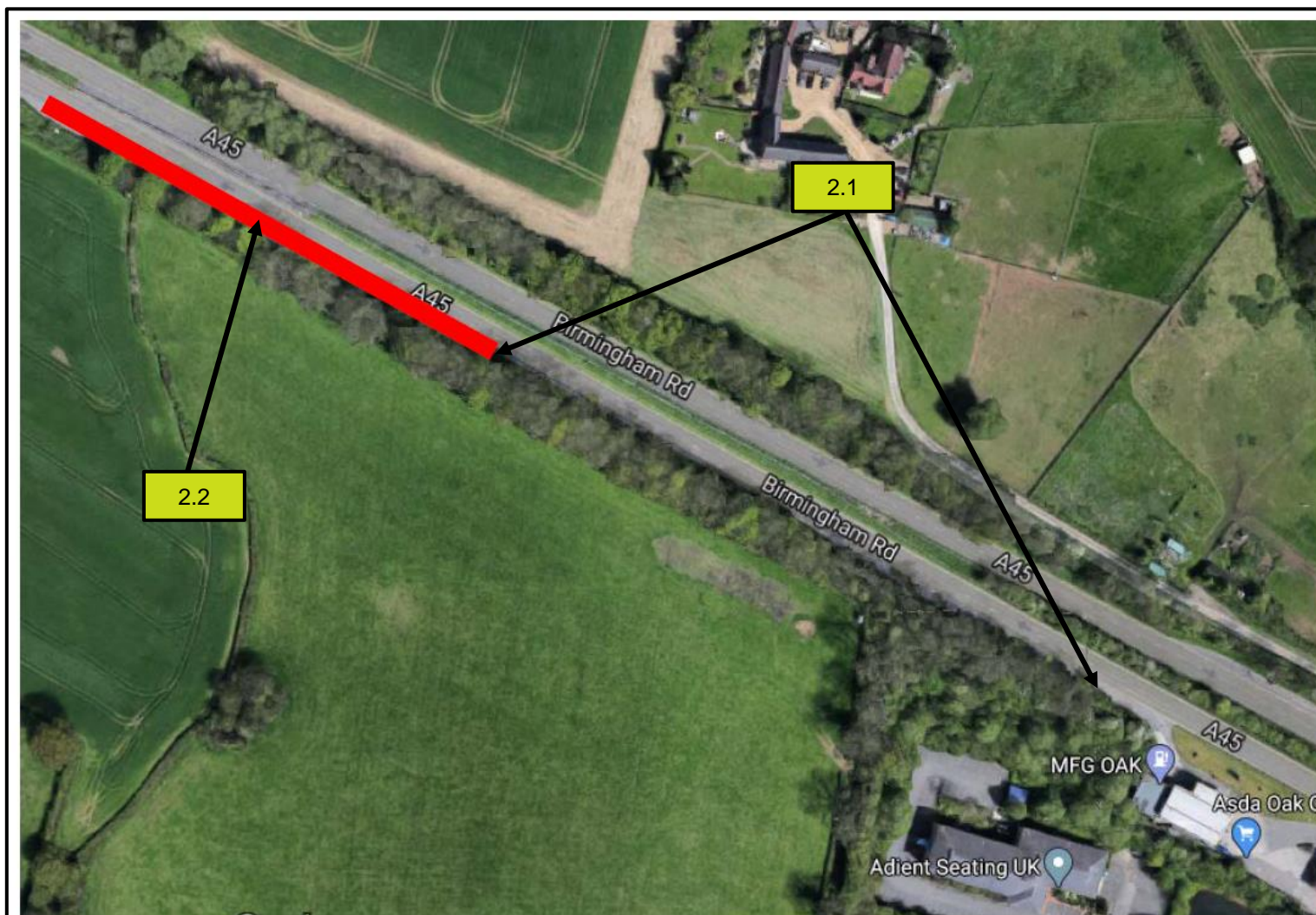

Figure 4e – Location 4